

TERRALET

BY 
LE TSA





PROFILE

LA 50: R-72 Rectangular 82 cm

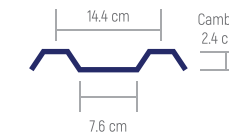
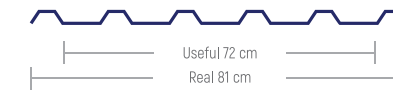

LA 70: R-101 Rectangular 1.07 cm

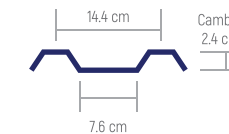
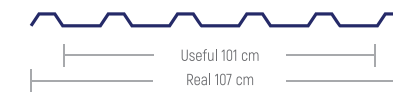

LA 20: 725 Wavy 100 cm

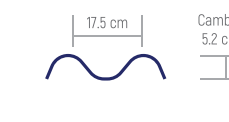
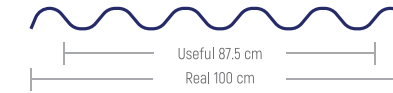

ADVANTAGES

- More than 10 years of durability
- Waterproof
- Sun resistant
- Chemical resistant
- Solvent resistant
- Does not corrode
- Affordable price
- Easy installation at a low cost
- Resistant to low and high temperatures
- Antibacterial
- Does not generate mold
- Moderate noise at the impact of rain

USES

Terralet is a very versatile product, that can be used to cover terraces, garages, swimming-pools and farms.



TERRALET
BY LETSA

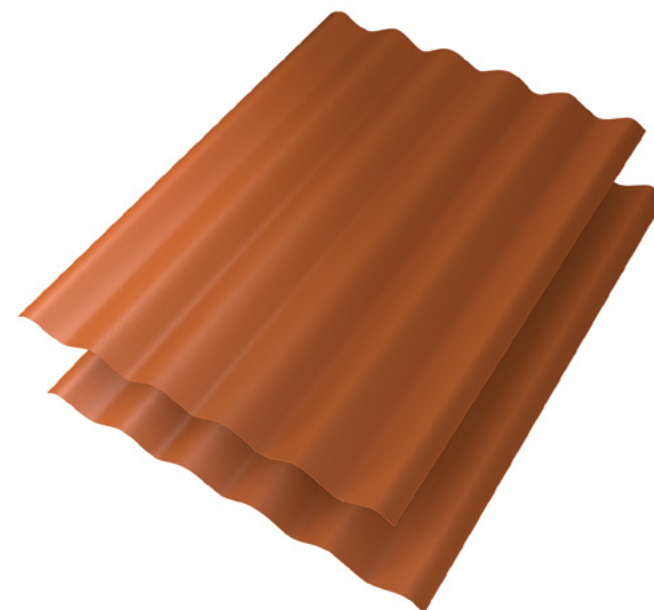

Terralet is a sheet made of acrylic-fiberglass and reinforced polyester, perfect for roofs and walls.

100%
MADE IN
MEXICO

HANDLING AND STORAGE:

You should consider the following storage indications regarding the TERRALET sheets when receiving merchandise from LETSA or any other delivery company. Please check the cargo with its shipping number in order to detect any possible anomaly or damage.

When lifting packages with forklifts, the forks must be at a 1.60 m distance. To avoid damaging the sheets, never handle open packages. Transport slowly in irregular roads in order to avoid any kind of folding in the sheets.

"If the sheet measures over 3 m, we recommend lifting with 2 or more individuals from only one side to avoid folding. Never lift the sheets by its ends or horizontally, it is difficult and dangerous.

Packages must be stored over the floor at a sufficient height in order to allow airflow and prevent water leaks.

If not installed immediately, the sheets must be stored near the installation place and over a firm surface to prevent any kind of damage.

We recommend consulting a professional to avoid any kind of damage during installation.

If while storing, the sheet makes contact with dust or other contaminant do not worry, because of the practicality of its materials it makes it very easy to clean, just take a damp towel and wipe the surface.



AVAILABLE COLORS



Red Terracota

Due to its excellent functionality in any climate, **Terralet** has been well accepted in countries that are very humid and hot.

	ASTM NORM	M.U.	VALUE
PHYSICAL PROPERTIES			
Yellowing	D-195	PSI	N/A
MECHANICAL PROPERTIES			
Bending resistance	D-790	PSI	21,439.5
Tension resistance	D-638	PSI	9,437.2
Tension resistance	D-256	PSI	10.01
Impact resistance	N/A	AEab	No change
CHEMICAL PROPERTIES			
Concentrated acids 15%	Sulfuric		No change
	Acetic		No change
	Hydrochloric		No change
	Nitric		No change
BASES			
Solvents	Ammonia		No change
	Sodium		No change
	Thinner		No change
	Gasoline		No change
LINE WEIGHT THICKNESS			
Thicknesses and times duration minimums	Duration 10 years	4 kg/m ²	2 mm

ATTACHMENTS AND OVERLAYS

LETSA recommends a professional or supervised installation. While its installation is very easy let's remember that not doing it correctly may damage the sheets. Minimum overlay recommended is 20 cm and the recommended distance between supports it's from 1.20m to a maximum of 1.40 m.

Attachment and overlay example:

Simple position



Double position (improves waterproofing)



LETSA RECOMMENDS:

TIP DRILL SCREW WITH PACKING RING:

Allows a clean and safe installation quick and with less effort, available with or without the galvanized EPDM ring which helps preventing leaks, the only ones with a 5 micron galvanization.

Tip #3 is designed to drill easily on sheets with a 0.36" to a 210" thickness.



HOOK FOR CONSTRUCTION SHEETS:

Due to its shape it is able to bend and this gives a high wind resistance. You can find them straight, "c" or "j" shaped usually with a PVC Rubber.



RECOMMENDATIONS WHILE INSTALLING

In case of many sheets assembly you should work transversally and have a 20 cm overlay. The overlap must not exceed 20 cm and we strongly suggest adequate gums to seal and avoid water condensation.

The recommended distance between supports is 1m minimum and a maximum of 1.40 m.

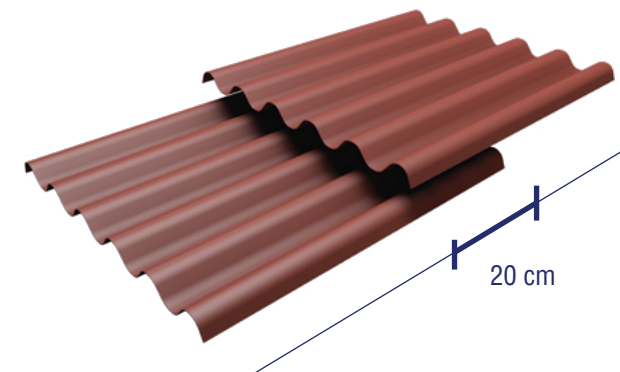

To facilitate the flow of rainwater, Letsa recommends the installation of the sheet with at least a 10% inclination.

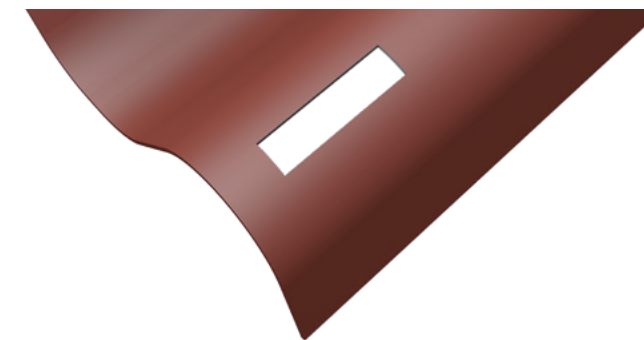
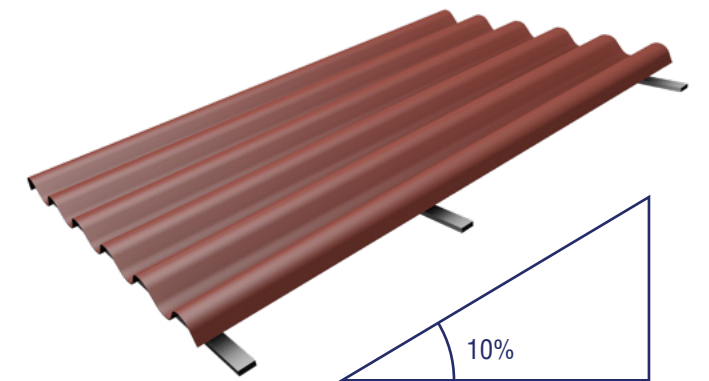

6mm Diameter screws	
Sheet length	Groove
Up to 2 m.	10 mm
Up to 4 m.	12 mm
Up to 6 m.	15 mm
Up to 8 m.	20 mm
Up to 10 m.	25 mm

IMPORTANT:

You must use a flat surface to step on the sheet.

Never allow the sheets to carry overweight. Use roof ladders while installing. Clean all disposable material in the sheets when finishing.

100%
MADE IN
MEXICO

LETSA
letsa.mx



letsa .mx

 **Km 1.5 Carretera Antigua San Isidro Mazatepec,**
San Agustin, Mpio Tlajomulco de Zuñiga, Jalisco, C.P. 45640

 **33 1011 3622**

01 (33) 3686 0765, 01 (33) 3686 0674
01 (33) 3686 2028, 01 (33) 3686 1065